

RoHS10 Support

REACH Support

CFSI Support

○形状 (SHAPE)

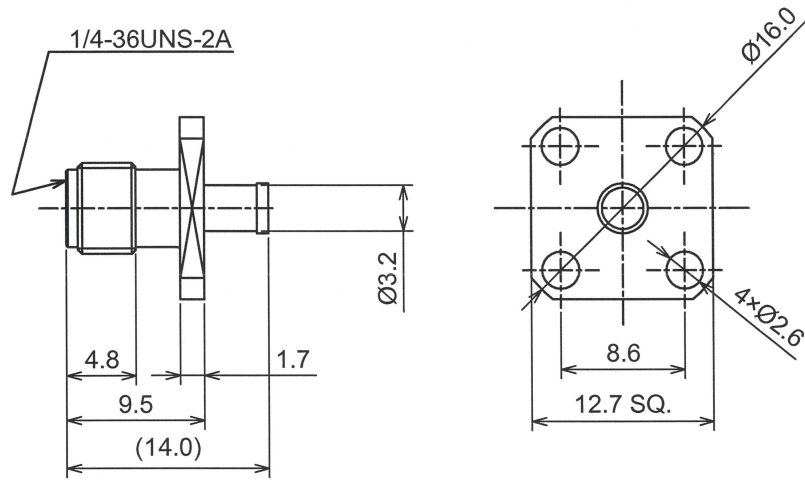

○規格 (Standard)  
MIL-C-39012

○仕様 (Specification)

- 特性インピーダンス (Impedance):  $50 \Omega$
- 定格周波数 (Working Frequency Range): DC~6GHz
- 電圧定在波比 (VSWR):  $\leq 1.25$  at 6GHz
- 挿入損失 (Insertion Loss): 0.03dB max
- 定格電圧 (Voltage Rating): 250V rms
- 耐電圧 (Proof Voltage): 335V rms
- 接触抵抗 (Contact Resistance): Inner 6.0/Outer 2.0 m $\Omega$  max
- 絶縁抵抗 (Insulation Resistance):  $\geq 5000M\Omega$
- 勤合保証回数 (Connector Life): 500 times min
- 使用温度範囲 (Temperature range):  $-65^{\circ}\text{C} \sim 155^{\circ}\text{C}$
- 推奨締め付けトルク (Recommended Torque) 0.8~1.0 Nm

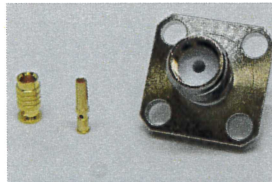

4	FERRULE	BRASS	GOLD
3	Contact	BeCu	GOLD
2	Dielectric	PTFE	NONE
1	Body	BRASS	NICKEL
No	DESCRIPTION	MATERIAL	FINISH

○加工寸法 (ASSEMBLY)

RECOMMENDED CABLE STRIPPING DIMS

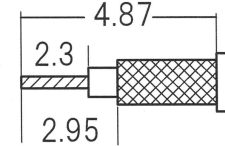

SOLDER CONTACT TO CABLE CENTER CONDUCTOR,  
BOTTOMING ON INSULATOR

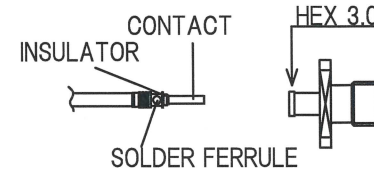

RECOMMENDED CLIPPING TOOL SIZE

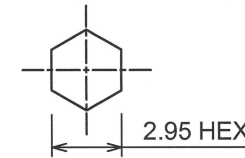

RECOMMENDED CRIMP HEIGHT  $3.00 \pm 0.1$

The tolerance in this area is  $\pm 0.10$

TOLERANCE DECIMALS .XX $\pm 0.10$ .X $\pm 0.15$ DIAMETER .X $\pm 0.10$				日本エレパーツ株式会社 NIHON ELEPARTS Co.,LTD		
Approved	Checked	Drawn				Unit mm
'22.02.01 山崎	'22.02.01 大江	'22.02.01 大江	A4	N A M E	SMA-PJ-0.8D	
					REV	1