

RoHS10 Support

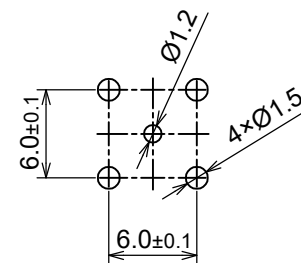
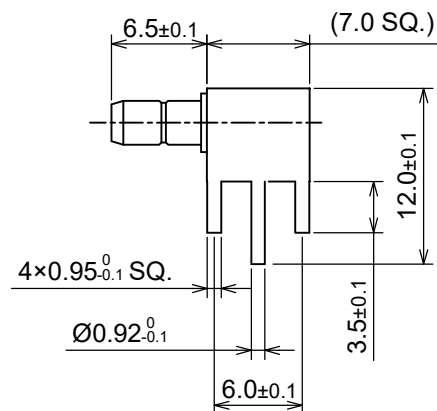

推奨 取付穴寸法

○規格 (Standard)
JIS-C-5415

○仕様 (Specification)

- 特性インピーダンス (Impedance) : 50 Ω
- 定格周波数 (Working Frequency Range) : DC~4GHz
- 電圧定在波比 (VSWR) : ≤1.35 at 3GHz
- 挿入損失 (Insertion Loss) : 0.04dB max × √f GHz (f:Frequency)
- 定格電圧 (Voltage Rating) : 335V rms
- 耐電圧 (Proof Voltage) : 1000V rms
- 接触抵抗 (Contact Resistance) : Inner 6.0/Outer 1.0 mΩ max
- 絶縁抵抗 (Insulation Resistance) : ≥1000MΩ
- 勤合保証回数 (Connector Life) : 500 times min

3	Contact	BRASS	GOLD
2	Dielectric	PTFE	NONE
1	Body	BRASS	NICKEL
No	DESCRIPTION	MATERIAL	FINISH

TOLERANCE DECIMALS .XX ±0.10 .X ±0.15 DIAMETER .X ±0.10				日本エレパーツ株式会社 NIHON ELEPARTS Co.,LTD	
Approved	Checked	Drawn			
			A4	N A M E SMB-RL-06	REV 1