

RoHS10 Support

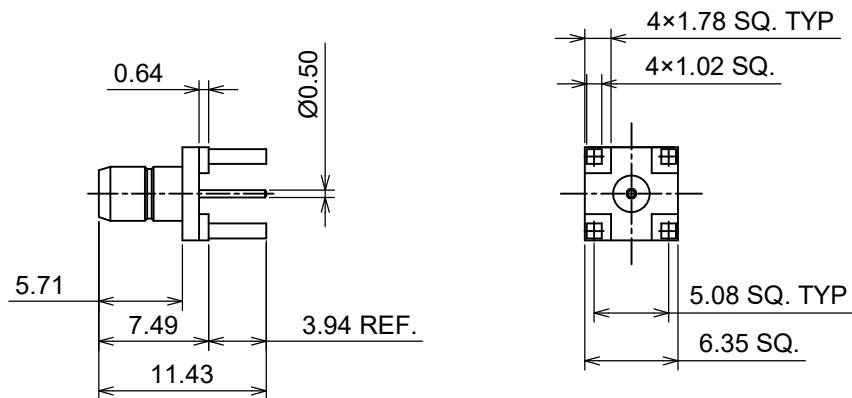

○規格 (Standard)  
MIL-C-39012

○仕様 (Specification)

- 特性インピーダンス (Impedance) : 75 Ω
- 定格周波数 (Working Frequency Range) : DC~4GHz
- 電圧定在波比 (VSWR) :  $\leq 1.25+0.04F$  max
- 挿入損失 (Insertion Loss) : 0.3dB
- 定格電圧 (Voltage Rating) : 335V rms
- 耐電圧 (Proof Voltage) : 1000V rms
- 接触抵抗 (Contact Resistance) : Inner 6.0/Outer 2.0 mΩ max
- 絶縁抵抗 (Insulation Resistance) :  $\geq 1000M\Omega$
- 勤合保証回数 (Connector Life) : 500 times min

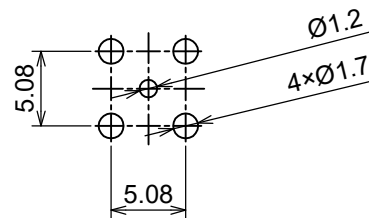

推奨 取付穴寸法

3	Contact	BRASS	GOLD
2	Dielectric	PTFE	NONE
1	Body	BRASS	NICKEL
No	DESCRIPTION	MATERIAL	FINISH

TOLERANCE DECIMALS .XX ±0.08 .X ±0.13 DIAMETER .X ±0.10				日本エレパーツ株式会社 NIHON ELEPARTS Co.,LTD	
Approved	Checked	Drawn			
			A4	N A M E SMB-RS-05C	REV 1